

PRODUCT DATASHEET

DOWNLIGHTS | DAMP-PROOF LUMINAIRES

Downlights | Surface mounted ceiling light | 30w | Round shape

Code# DPR20011E-30



Areas of Application

- Outdoor
- Garden
- Parking
- Garage
- Balcony
- Bathroom, kitchen, corridor, toilet, residential interiors

Product Features

- IP65 waterproof
- High luminous efficacy, high CRI
- Die-cast aluminum housing, ensure excellent heat dissipation
- Energy savings of up to 90% compared to halogen lamp spotlights
- CCT optional and dimmable
- High transmission lampshade
- Anti-glare, without flicker
- Easy and quick installation

Complete Product Data

| | |
|----------------------------|--------------|
| Code# | DPR20011E-30 |
| Wattage | 30w |
| Installation Type | Surface |
| Dimension | φ360mm*110mm |
| Cutout | / |
| IP Rating | IP65 |
| Luminous Flux | 2250lm |
| Beam Angle | / |
| Working Temperature | -25°C ~55°C |
| Certificates | / |
| Warranty | 3 Years |
| Packing Size | / |

Driver Data

| | |
|-----------------------|---|
| Driver Brand | Tridonic, Osram, Philips, Lifud, Euchips, Eaglerise, etc. |
| Input Voltage | 100-250VAC 50/60hz |
| Output Voltage | 24-42Vdc |
| Output Current | 750mA |
| Power Factor | >0.5 as standard; >0.9 optional |
| Efficiently | 87% @230v |
| IP Rating | IP20 |
| Dimmable | Non-Dimmable/Triac/0-10v/Dali Optional |
| Free Flicker | Yes |
| Certificates | CE, CB, CCC, ENEC |
| Warranty | 3/5 Years |

Material&Housing Data

| | |
|-------------------------|-----------------------------------|
| Housing Color | Sand black/ Sand white/ Sand grey |
| Reflector Color | / |
| Housing Material | Die-cast Alumininum + PC |

Photometric Data

| | |
|--------------------------|--------------------------------------|
| LED chip brand | Cree/ Osram /Bridgelux/ Epistar etc. |
| Chip Type | SMD |
| Color Temperature | 2700K, 3000K, 4000K, 6000K |
| CRI | >80 |
| Life time | >50000Hrs |
| Lumens efficacy | 100-120lm/w |

Dimensions&Installation

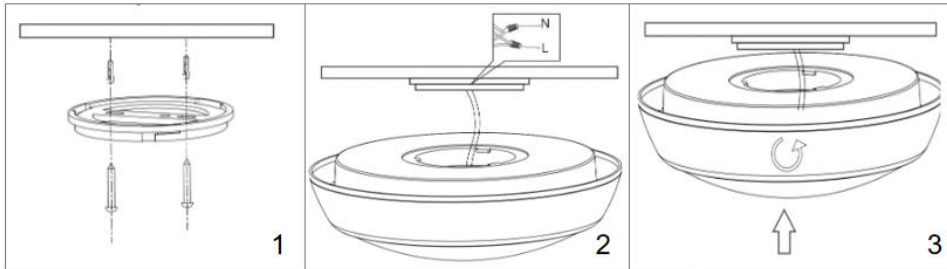
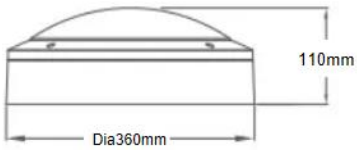

PLEASE FIND A QUALIFIED ELECTRICIAN FOR INSTALLATION. Please read the instructions before you install and use the ceiling light.

1. Make sure the power is turned off in which you are installing the products.
2. Fix the screws through the underbed. (Fig 1)
3. Connecting the L/N wire accordingly in the junction box. (Fig 2)
4. Hold the lamp and rotate clockwise, Fix it with screws. (Fig 3)
5. Restore power at the source and the installation is complete.