

PRODUCT DATASHEET

OUTDOOR LIGHTING | OUTDOOR WALL MOUNTED

Outdoor lighting | Ceiling mounted light | 12w | Column shape | IP65

Code# OTWM20001-12



Areas of Application

- Courtyard
- Park
- Villa
- Corridor

Product Features

- IP65
- Aluminum Die-casting lamp body, Opal PC Diffuser,
- Powder coating White/Black optional
- High luminous efficacy, high CRI
- Anti-glare, without flicker
- Easy and quick installation

Complete Product Data

Code#	OTWM20001-12
Wattage	12w
Installation Type	Ceiling-Mounted
Dimension	Φ110*200
Cutout	/
IP Rating	IP65
Luminous Flux	100lm/W
Beam Angle	Wide
Working Temperature	-25°C ~55°C
Certificates	/
Warranty	3 Years
Packing Size	/

Driver Data

Driver Brand	Tridonic, Osram, Philips, Lifud, Euchips, Eaglerise, etc.
Input Voltage	100-250VAC 50/60hz
Output Voltage	/
Output Current	/
Power Factor	>0.5 as standard; >0.9 optional
Efficiently	87% @230v
IP Rating	IP20
Dimmable	Non-Dimmable/Triac/0-10v/Dali Optional
Free Flicker	Yes
Certificates	CE, CB, CCC, ENEC
Warranty	3/5 Years

Material&Housing Data

Light Body Color	White/Black
Reflector Color	/
Light Body Material	Die-casting Aluminum

Photometric Data

LED chip brand	Cree/ Osram /Bridgelux/ Epistar etc.
Chip Type	SMD2835/E27
Color Temperature	2700K, 3000K, 4000K, 6000K
CRI	>80
Life time	>50000Hrs
Lumens efficacy	100-120lm/w

Dimensions&Installation

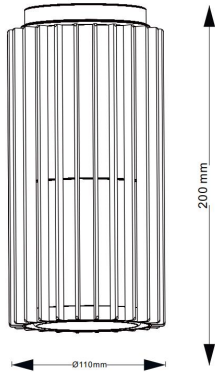

PLEASE FIND A QUALIFIED ELECTRICIAN FOR INSTALLATION. Please read the instructions before you install and use the outdoor wall-mounted light.

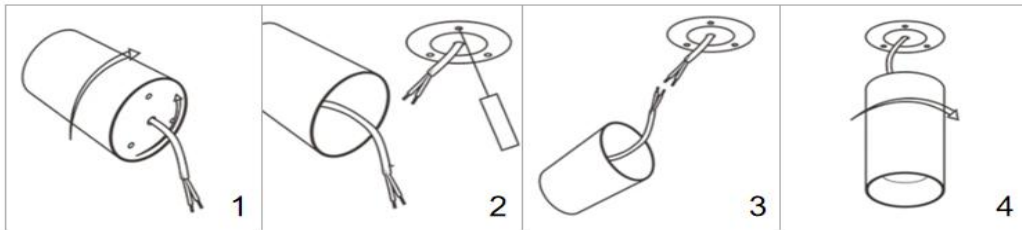

Ceiling mounted

1. Make sure the power is turned off in which you are installing the products.
2. Rotate the lamp body clockwise, rotate the base to separate from the lamp body anticlockwise. (Fig 1)
3. Fix the base with the screwdriver. (Fig 2)
4. Connect the input terminal to the main power supply. (Fig 3)
5. Rotate the housing base with the pedestal anticlockwise for fixation. (Fig 4)
6. Restore power at the source and the installation is complete.