

# PRODUCT DATASHEET

## OUTDOOR LIGHTING | SPIKE & STEP LIGHTS

Outdoor lighting | Surface mounted spike & step light | 5w | Round shape

Code# OTSP18002-5



---

### Areas of Application

- Garden
- Patio
- Bridge
- Landscap
- Outdoor decoration lighting

---

### Product Features

- IP65 waterproof
- High luminous efficacy, high CRI
- Anti-glare honeycomb and lens hood for option
- Uniform light output and good consistency
- CCT optional and dimmable
- Die-cast aluminum housing, ensure excellent heat dissipation
- 180° adjustable lamp holder
- Easy and quick installation

---

## Complete Product Data

<b>Code#</b>	OTSP18002-5
<b>Wattage</b>	5w
<b>Installation Type</b>	Surface
<b>Dimension</b>	40mm*75mm*250mm
<b>Cutout</b>	/
<b>IP Rating</b>	IP65
<b>Luminous Flux</b>	400lm
<b>Beam Angle</b>	24°
<b>Working Temperature</b>	-25°C ~55°C
<b>Certificates</b>	/
<b>Warranty</b>	3 Years
<b>Packing Size</b>	/

## Driver Data

<b>Driver Brand</b>	Tridonic, Osram, Philips, Lifud, Euchips, Eaglerise, etc.
<b>Input Voltage</b>	DC24V/AC220V
<b>Output Voltage</b>	/
<b>Output Current</b>	/
<b>Power Factor</b>	>0.5 as standard; >0.9 optional
<b>Efficiently</b>	87% @230v
<b>IP Rating</b>	IP20
<b>Dimmable</b>	Non-Dimmable/Triac/0-10v/Dali Optional
<b>Free Flicker</b>	Yes
<b>Certificates</b>	CE, CB, CCC, ENEC
<b>Warranty</b>	3/5 Years

## Material&Housing Data

<b>Housing Color</b>	Black
<b>Reflector Color</b>	/
<b>Housing Material</b>	/

## Photometric Data

<b>LED chip brand</b>	Cree/ Osram /Bridgelux/ Epistar etc.
<b>Chip Type</b>	COB
<b>Color Temperature</b>	2700K, 3000K, 4000K, 6000K
<b>CRI</b>	>80
<b>Life time</b>	>50000Hrs
<b>Lumens efficacy</b>	100-120lm/w

## Dimensions&Installation

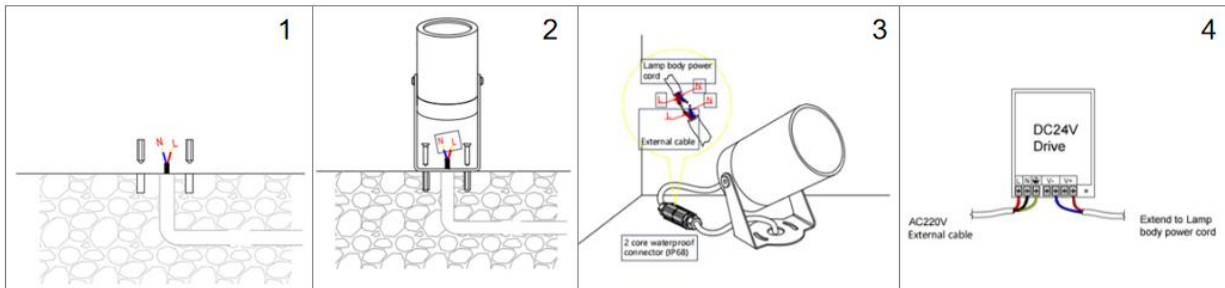
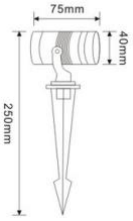

**PLEASE FIND A QUALIFIED ELECTRICIAN FOR INSTALLATION.** Please read the instructions before you install and use the light.

1. Make sure the power is turned off in which you are installing the products.
2. Drill holes in the ground or wall according to size, Embedded plastic expansion pipe. (fig 1)
3. Use self-tapping screws to fix the lamps. (fig 2)
4. Use 2 core waterproof connector to connect the lamp power cord to the input power cord. (fig 3)
5. DC24V Diving wiring method for option: connect the lamp power cord to the drive output power cord, and connect AC220V external cable to the drive input power cord. (fig 4)
6. Restore power at the source and the installation is complete.