

PRODUCT DATASHEET

OUTDOOR LIGHTING | SPIKE & STEP LIGHTS

Outdoor lighting | Surface mounted spike & step light | 3w | Round shape

Code# OTSP18001-3



Areas of Application

- Garden
- Patio
- Bridge
- Landscap
- Outdoor decoration lighting

Product Features

- IP65 waterproof
- High luminous efficacy, high CRI
- Anti-glare honeycomb for option
- Uniform light output and good consistency
- CCT optional and dimmable
- Die-cast aluminum housing, ensure excellent heat dissipation
- 180° adjustable lamp holder
- Easy and quick installation

Complete Product Data

Code#	OTSP18001-3
Wattage	3w
Installation Type	Surface
Dimension	40mm*75mm*70mm
Cutout	/
IP Rating	IP65
Luminous Flux	240lm
Beam Angle	24°
Working Temperature	-25°C ~55°C
Certificates	/
Warranty	3 Years
Packing Size	/

Driver Data

Driver Brand	Tridonic, Osram, Philips, Lifud, Euchips, Eaglerise, etc.
Input Voltage	DC24V/AC220V
Output Voltage	/
Output Current	/
Power Factor	>0.5 as standard; >0.9 optional
Efficiently	87% @230v
IP Rating	IP20
Dimmable	Non-Dimmable/Triac/0-10v/Dali Optional
Free Flicker	Yes
Certificates	CE, CB, CCC, ENEC
Warranty	3/5 Years

Material&Housing Data

Housing Color	Grey/ Black
Reflector Color	/
Housing Material	Aluminum

Photometric Data

LED chip brand	Cree/ Osram /Bridgelux/ Epistar etc.
Chip Type	COB
Color Temperature	2700K, 3000K, 4000K, 6000K
CRI	>80
Life time	>50000Hrs
Lumens efficacy	100-120lm/w

Dimensions&Installation

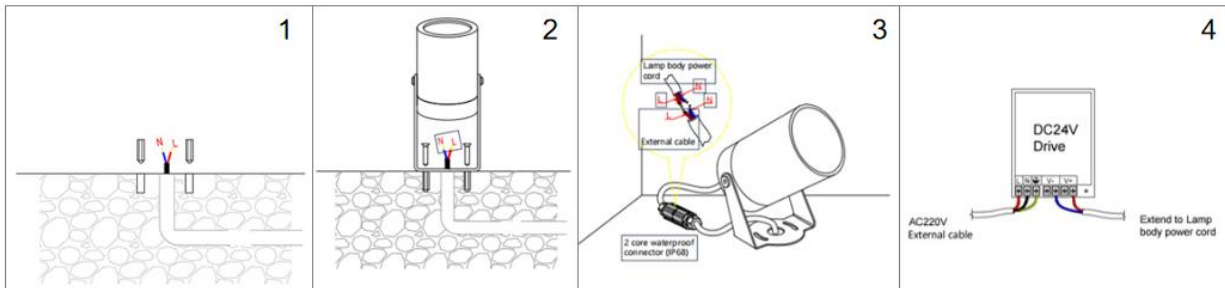
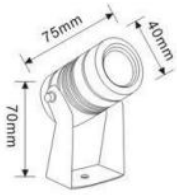

PLEASE FIND A QUALIFIED ELECTRICIAN FOR INSTALLATION. Please read the instructions before you install and use the light.

1. Make sure the power is turned off in which you are installing the products.
2. Drill holes in the ground or wall according to size, Embedded plastic expansion pipe. (fig 1)
3. Use self-tapping screws to fix the lamps. (fig 2)
4. Use 2 core waterproof connector to connect the lamp power cord to the input power cord. (fig 3)
5. DC24V Diving wiring method for option: connect the lamp power cord to the drive output power cord, and connect AC220V external cable to the drive input power cord. (fig 4)
6. Restore power at the source and the installation is complete.