

# PRODUCT DATASHEET

## DOWNLIGHTS | SPOTLIGHTS-IP RATED

Downlights | Surface mounted spotlight | 6w | Round shape

Code# WPC20006-6



---

### Areas of Application

- Courtyard
- Garden
- Villa
- Balcony
- Bathroom, kitchen, residential interiors

---

### Product Features

- IP65 waterproof
- Uniform light output and good consistency
- High luminous efficacy, high CRI
- Anti-glare, without flicker
- Energy savings of up to 90% compared to halogen lamp spotlights
- Die-cast aluminum housing, ensure excellent heat dissipation
- CCT optional and dimmable
- Easy and quick installation

---

## Complete Product Data

<b>Code#</b>	WPC20006-6
<b>Wattage</b>	6w
<b>Installation Type</b>	Surface
<b>Dimension</b>	φ65mm*H120mm
<b>Cutout</b>	/
<b>IP Rating</b>	IP65
<b>Luminous Flux</b>	450lm
<b>Beam Angle</b>	20°, 40°
<b>Working Temperature</b>	-25°C ~55°C
<b>Certificates</b>	/
<b>Warranty</b>	3 Years
<b>Packing Size</b>	/

## Driver Data

<b>Driver Brand</b>	Tridonic, Osram, Philips, Lifud, Euchips, Eaglerise, etc.
<b>Input Voltage</b>	100-250VAC 50/60hz
<b>Output Voltage</b>	30-42Vdc
<b>Output Current</b>	150mA
<b>Power Factor</b>	>0.5 as standard; >0.9 optional
<b>Efficiently</b>	87% @230v
<b>IP Rating</b>	IP65
<b>Dimmable</b>	Non-Dimmable/Triac/0-10v/Dali Optional
<b>Free Flicker</b>	Yes
<b>Certificates</b>	CE, CB, CCC, ENEC
<b>Warranty</b>	3/5 Years

## Material&Housing Data

<b>Housing Color</b>	Black/ White/ Silver/ Grey/ Brown
<b>Reflector Color</b>	/
<b>Housing Material</b>	Die-casting Aluminum

## Photometric Data

<b>LED chip brand</b>	Cree/ Osram /Bridgelux/ Epistar etc.
<b>Chip Type</b>	COB
<b>Color Temperature</b>	2700K, 3000K, 4000K, 6000K
<b>CRI</b>	>80
<b>Life time</b>	>50000Hrs
<b>Lumens efficacy</b>	100-120lm/w

---

## Dimensions&Installation

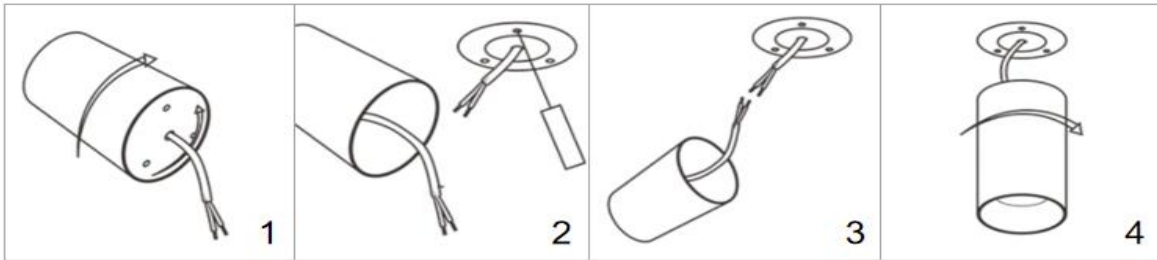
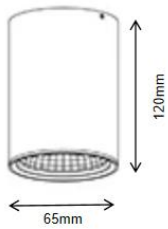

**PLEASE FIND A QUALIFIED ELECTRICIAN FOR INSTALLATION.** Please read the instructions before you install and use the downlight.

1. Make sure the power is turned off in which you are installing the products.
2. Rotate the lamp body clockwise, rotate the base to separate from the lamp body anticlockwise. (Fig 1)
3. Fix the base with the screwdriver. (Fig 2)
4. Connect the input terminal to the main power supply. (Fig 3)
5. Rotate the housing base with the pedestal anticlockwise for fixation. (Fig 4)
6. Restore power at the source and the installation is complete.