

PRODUCT DATASHEET

PANEL LIGHT | SUSPENDED & SURFACE MOUNTED

Panel light | Suspended & Surface mounted panel light 24w | Round shape

Code# PR01001-30



Areas of Application

- Gym
- Library
- Office
- Club
- Shops
- Living room, restaurant, residential interiors

Product Features

- High luminous efficacy, high CRI
- Energy savings of up to 90% compared to halogen lamp spotlights
- CCT optional and dimmable
- Die-cast aluminum housing, ensure excellent heat dissipation
- High transmission lampshade
- Anti-glare, without flicker
- Easy and quick installation

Complete Product Data

Code#	PR01001-30
Wattage	24w
Installation Type	Suspended/Surface
Dimension	φ300mm*W20mm*H1200mm
Cutout	/
IP Rating	IP20
Luminous Flux	1920lm
Beam Angle	120°
Working Temperature	-25°C ~55°C
Certificates	/
Warranty	3 Years
Packing Size	/

Driver Data

Driver Brand	Tridonic, Osram, Philips, Lifud, Euchips, Eaglerise, etc.
Input Voltage	100-250VAC 50/60hz
Output Voltage	27-39Vdc
Output Current	600mA
Power Factor	>0.5 as standard; >0.9 optional
Efficiently	87% @230v
IP Rating	IP20
Dimmable	Non-Dimmable/Triac/0-10v/Dali Optional
Free Flicker	Yes
Certificates	CE, CB, CCC, ENEC
Warranty	3/5 Years

Material&Housing Data

Housing Color	White/ Black
Reflector Color	/
Housing Material	Aluminum

Photometric Data

LED chip brand	Cree/ Osram /Bridgelux/ Epistar etc.
Chip Type	SMD
Color Temperature	2700K, 3000K, 4000K, 5000K, 6000K
CRI	>80
Life time	>50000Hrs
Lumens efficacy	100-120lm/w

Dimensions&Installation

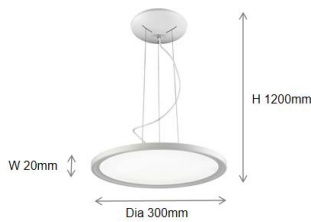

PLEASE FIND A QUALIFIED ELECTRICIAN FOR INSTALLATION. Please read the instructions before you install and use the panel light.

Method A: Surface Mounted

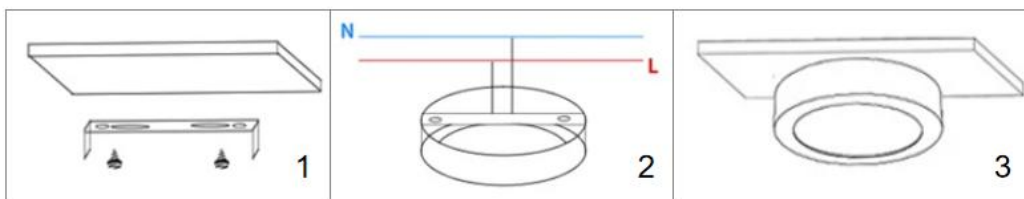

1. Make sure the power is turned off in which you are installing the products.
2. Fix the bracket on the flowering board and reinforce it with screws. (Fig 1)
3. The power supply is fixed at the bottom of the lamp, and the two wires are connected to the power line L/N. (Fig 2)
4. Restore power at the source and the installation is complete. (Fig 3)

Method B: Suspended Mounted

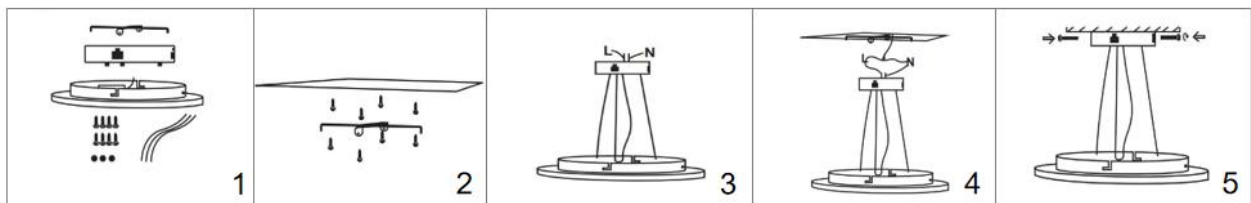

1. Make sure the power is turned off in which you are installing the products.
2. Prepare the accessories for suspended installation. (Fig 1)
3. Install the bracket on the ceiling. (Fig 2)
4. Install a suspension wire on the lamp body. (Fig 3)
5. Connect the electronic cable L & N from indoor with the terminal on the lamps and connect the suspension wire to the bracket (while there is grounding wire, same methods). (Fig 4)
6. Fix the entire base with screws, restore power at the source and the installation is complete. (Fig 5)

SHENZHEN VIVISOMA CO.,LIMITED

ADD: Office3A09,4# ShenLong West Lane, Longtian Street, PingShan District, Shenzhen, China.
sales@vivisomaled.com

www.vivisomaled.com