

# PRODUCT DATASHEET

## DOWNLIGHTS | SPOTLIGHTS-PAINTABLE PLASTER LIGHT

Downlights | Recessed mounted spotlight | Square shape

Code# GW07028-300

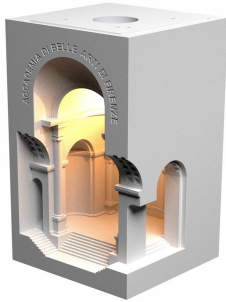

---

### Areas of Application

- Shops
- Villa
- Hotel
- Club
- Corridors, stairways, entrance areas
- Galleries, museums residential interiors

---

### Product Features

- High luminous efficacy, high CRI
- CCT optional and dimmable
- Uniform light output and good consistency
- Without flicker, anti glare
- Easy and quick installation

---

## Complete Product Data

<b>Code#</b>	GW07028-300
<b>Light Source</b>	MR11
<b>Installation Type</b>	/
<b>Dimension</b>	300mm*165mm*165mm
<b>Cutout</b>	/
<b>IP Rating</b>	IP20
<b>Luminous Flux</b>	/
<b>Beam Angle</b>	/
<b>Working Temperature</b>	-25°C ~55°C
<b>Certificates</b>	/
<b>Warranty</b>	3 Years
<b>Packing Size</b>	/

## Driver Data

<b>Driver Brand</b>	/
<b>Input Voltage</b>	100-250VAC 50/60hz
<b>Output Voltage</b>	/
<b>Output Current</b>	/
<b>Power Factor</b>	/
<b>Efficiently</b>	/
<b>IP Rating</b>	IP20
<b>Dimmable</b>	Non-Dimmable/Triac/0-10v/Dali Optional
<b>Free Flicker</b>	Yes
<b>Certificates</b>	CE, CB, CCC, ENEC
<b>Warranty</b>	3/5 Years

## Material&Housing Data

<b>Housing Color</b>	White
<b>Reflector Color</b>	White
<b>Housing Material</b>	Gypsum

## Photometric Data

<b>LED chip brand</b>	/
<b>Chip Type</b>	MR11
<b>Color Temperature</b>	2700K, 3000K, 4000K, 5000K, 6000K
<b>CRI</b>	/
<b>Life time</b>	/
<b>Lumens efficacy</b>	/

---

## Dimensions&Installation

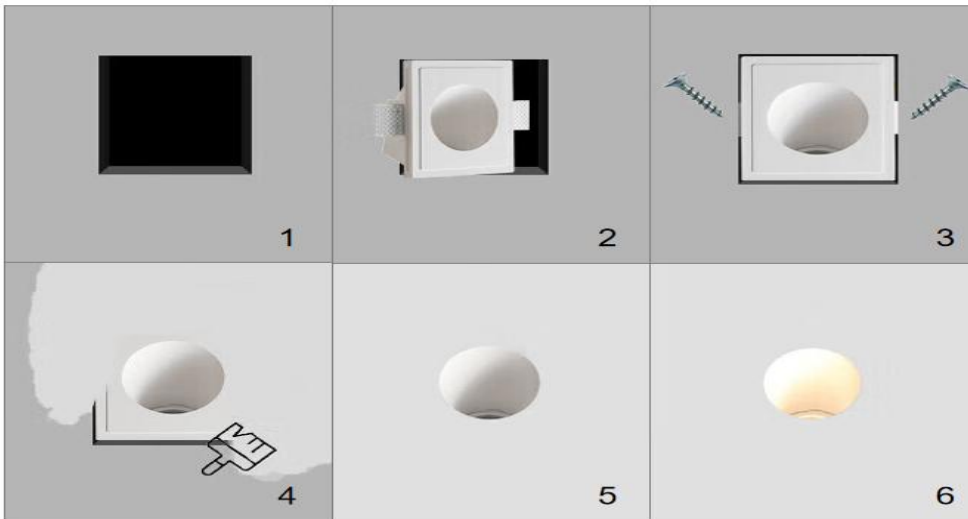
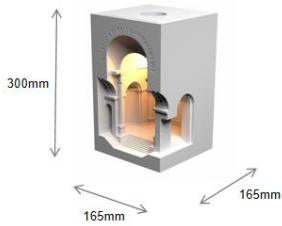

**PLEASE FIND A QUALIFIED ELECTRICIAN FOR INSTALLATION.** Please read the instructions before you install and use the downlight.

1. Make sure the power is turned off in which you are installing the products.
2. Open the hole in the wall according to the lamp size. (Fig 1)
3. Put the embedded parts of lamps into back side, pay attention to pull the wire out. (Fig 2)
4. The self-tapping screw goes through the wall and locks the embedded wings of the lamp. (Fig 3)
5. The edge of embedded parts is gray until the edge smooth with wall. (Fig 4)
6. Light source module of lamps and lanterns, after being connected to the mains supply push the module into the embedded part. (Fig 5)
7. Install the fixed card, and the installation is complete electric test light. (Fig 6)