

PRODUCT DATASHEET

DOWNLIGHTS | SPOTLIGHTS-ROUND

Downlights | Recessed mounted spotlight | Modular type | 40w | Round shape | Deep Anti-Glare
Code# RM01009-40



Areas of Application

- Hotel rooms
- Bath rooms
- Hospital
- Office rooms
- Shops
- Semi outdoor Corridors
- Stairways, entrance areas
- Galleries

Product Features

- High luminous efficacy
- Anti-glare
- Die-cast aluminum housing, ensure excellent heat dissipation
- Uniform light output and good consistency
- CCT optional and dimmable
- CRI>90
- IP20/IP44 optional
- Easy and quick installation
- 3 years warranty

Complete Product Data

Code#	RM01009-40
Wattage	40w
Installation Type	Recessed
Dimension	φ165mm*H132mm
Cutout	φ150mm
IP Rating	IP20/IP44
Luminous Flux	3200lm
Beam Angle	15° 24° 38°
Working Temperature	-25°C~55°C
Certificates	/
Warranty	3 Years
Packing Size	/

Driver Data

Driver Brand	Tridonic, Osram, Philips, Lifud, Euchips, Eaglerise, etc.
Input Voltage	100-250VAC 50/60hz
Output Voltage	24-40Vdc
Output Current	1000mA
Power Factor	>0.95
Efficiently	87% @230v
IP Rating	IP20
Dimmable	Non-Dimmable/Triac/0-10v/Dali Optional
Free Flicker	Yes
Certificates	CE, CB, CCC, ENEC
Warranty	3/5 Years

Material&Housing Data

Housing Color	Gray
Housing Material	Die-casting Aluminum
Reflector Color	Black/Glossy silver/Golden/Matt Silver
Trim Color	White/Black

Photometric Data

LED chip brand	Cree/ Osram /Bridgelux/ Epistar etc.
Chip Type	COB
Color Temperature	2700K, 3000K, 4000K, 5000K, 6000K, 6500K
CRI	>80, >90
Life time	>50000Hrs
Lumens efficacy	110-135lm/w

Dimensions&Installation

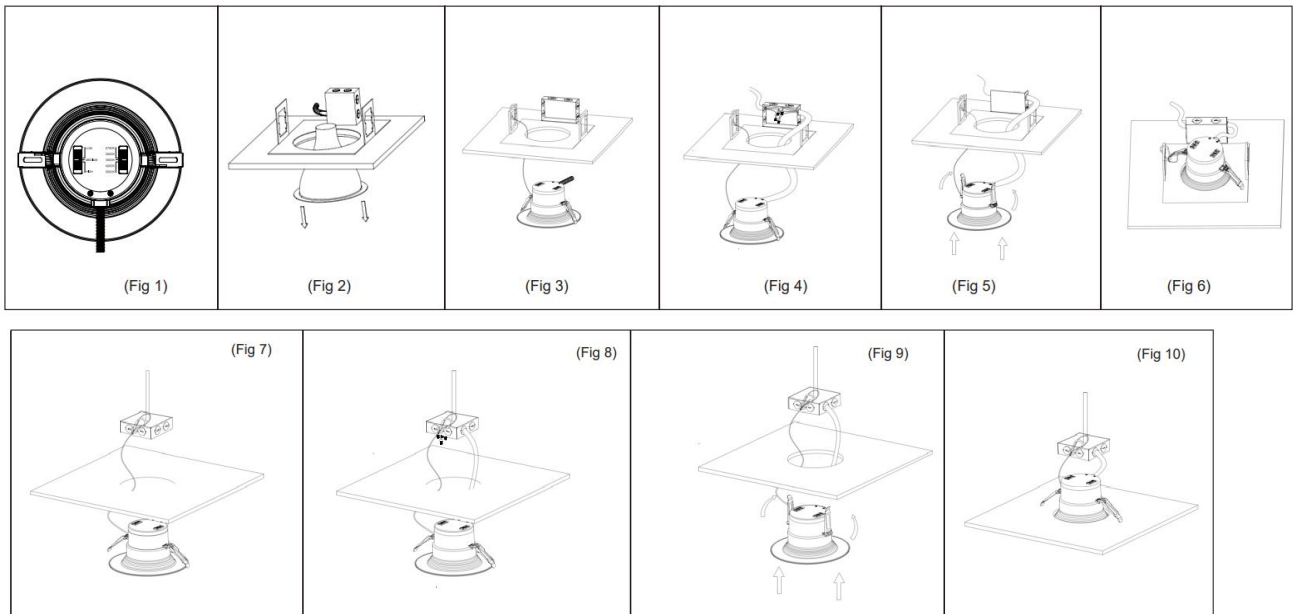

PLEASE FIND A QUALIFIED ELECTRICIAN FOR INSTALLATION. Please read the instructions before you install and use the downlight.

1. Make sure the power is turned off in which you are installing the products.
2. If existing lamp and trim are present, remove from ceiling or move it out of the way as it will not be needed during installation. Measure the ceiling opening to make sure the edge of the downlight will cover the entire hole and still sit firmly in the ceiling before proceeding. (Fig 2)
3. Insert lamp conduit into the box and wire to power source (black to hot, white to neutral) (Fig. 4).
4. Squeeze the two housing clips so they are in an upright position and insert lamp into housing. (Fig 5)
5. Once lamp is inside the housing, release the housing clips and continue pushing lamp into housing until securely fixed and flush with ceiling. (Fig 6)
6. Restore power at the source and the installation is complete.