

# PRODUCT DATASHEET

## DOWNLIGHTS | SPOTLIGHTS-ROUND

Downlights | Recessed mounted spotlight | Modular type | 9w | Round shape | Deep Anti-Glare  
Code# RM01009-9



---

### Areas of Application

- Hotel rooms
- Bath rooms
- Hospital
- Office rooms
- Shops
- Semi outdoor Corridors
- Stairways, entrance areas
- Galleries

---

### Product Features

- High luminous efficacy
- Anti-glare
- Die-cast aluminum housing, ensure excellent heat dissipation
- Uniform light output and good consistency
- CCT optional and dimmable
- CRI>90
- IP20/IP44 optional
- Easy and quick installation
- 3 years warranty

---

## Complete Product Data

<b>Code#</b>	RM01009-9
<b>Wattage</b>	9w
<b>Installation Type</b>	Recessed
<b>Dimension</b>	φ90mm*H76mm
<b>Cutout</b>	φ75mm
<b>IP Rating</b>	IP20/IP44
<b>Luminous Flux</b>	720lm
<b>Beam Angle</b>	15° 24° 38°
<b>Working Temperature</b>	-25°C~55°C
<b>Certificates</b>	/
<b>Warranty</b>	3 Years
<b>Packing Size</b>	/

## Driver Data

<b>Driver Brand</b>	Tridonic, Osram, Philips, Lifud, Euchips, Eaglerise, etc.
<b>Input Voltage</b>	100-250VAC 50/60hz
<b>Output Voltage</b>	22-42Vdc
<b>Output Current</b>	200mA
<b>Power Factor</b>	>0.9
<b>Efficiently</b>	78% @230v
<b>IP Rating</b>	IP20
<b>Dimmable</b>	Non-Dimmable/Triac/0-10v/Dali Optional
<b>Free Flicker</b>	Yes
<b>Certificates</b>	CE, CB, CCC, ENEC
<b>Warranty</b>	3/5 Years

## Material&Housing Data

<b>Housing Color</b>	Gray
<b>Housing Material</b>	Die-casting Aluminum
<b>Reflector Color</b>	Black/Glossy silver/Golden/Matt Silver
<b>Trim Color</b>	White/Black

## Photometric Data

<b>LED chip brand</b>	Cree/ Osram /Bridgelux/ Epistar etc.
<b>Chip Type</b>	COB
<b>Color Temperature</b>	2700K, 3000K, 4000K, 5000K, 6000K, 6500K
<b>CRI</b>	>80, >90
<b>Life time</b>	>50000Hrs
<b>Lumens efficacy</b>	110-135lm/w

---

## Dimensions&Installation

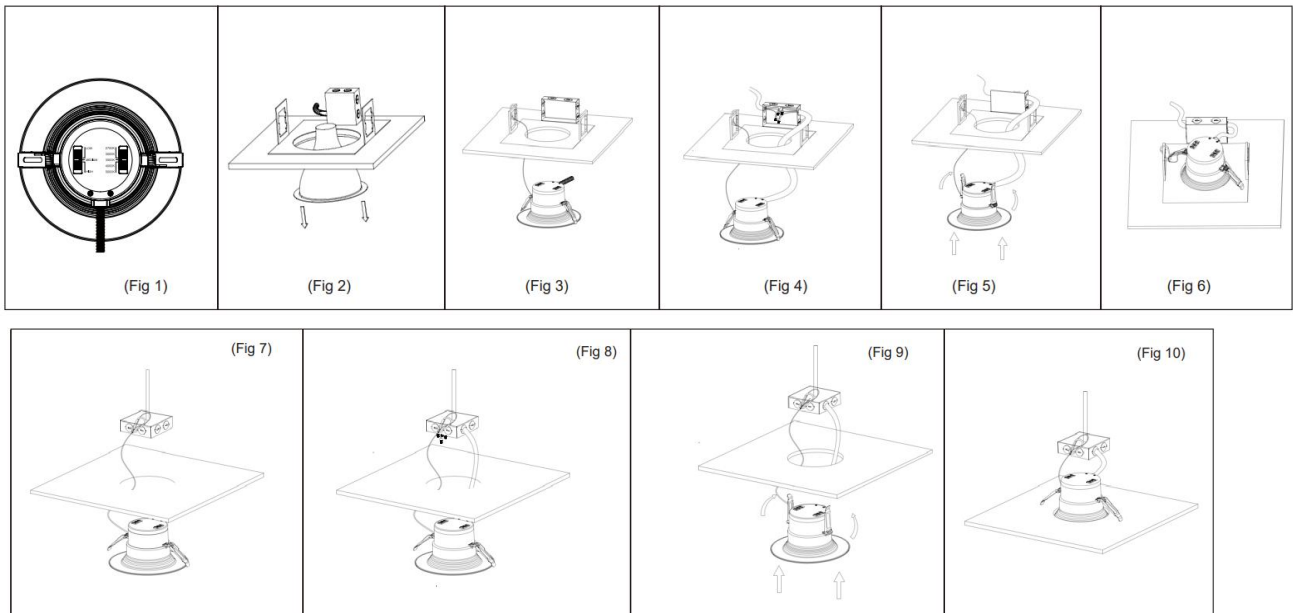

**PLEASE FIND A QUALIFIED ELECTRICIAN FOR INSTALLATION.** Please read the instructions before you install and use the downlight.

1. Make sure the power is turned off in which you are installing the products.
2. If existing lamp and trim are present, remove from ceiling or move it out of the way as it will not be needed during installation. Measure the ceiling opening to make sure the edge of the downlight will cover the entire hole and still sit firmly in the ceiling before proceeding. (Fig 2)
3. Insert lamp conduit into the box and wire to power source (black to hot, white to neutral ) (Fig. 4).
4. Squeeze the two housing clips so they are in an upright position and insert lamp into housing. (Fig 5)
5. Once lamp is inside the housing, release the housing clips and continue pushing lamp into housing until securely fixed and flush with ceiling. (Fig 6)
6. Restore power at the source and the installation is complete.